

XL Series Retrofit Non-Cassette

ID6SU4 • ID6SU6 • ID6SU8 • ID6SU12

Specifically for Hussmann Insight Cases

KNOW BEFORE YOU INSTALL

'Dot & Triangle' markings on metal tab-end (right end/spring end) must be at **BOTTOM** when installing.

And must be at **TOP** when adding/releasing spring tension. See page 2 Troubleshooting to learn how.

PRO-TIP #1

Pro-Tip #1 - mark the bottom of the metal tab with a red Sharpie while it's lined up with the "dot & triangle" to easily confirm dot & triangle are at the bottom when installing. See page 2 Troubleshooting to learn more.

PRO-TIP #2

Due to temperature variations during transit, & general transit conditions, retraction speed may be slower than desired when night cover is installed.

Pro-Tip #2 - increase the spring tension one 'wind' (clockwise 360° turn of the spring) **BEFORE** installing! See page 2 Troubleshooting to learn how & to learn more.

PRO-TIP #3

Metal tab on spring end (right-end) of night cover is (slightly) adjustable - to compensate for tolerances in the pre-installed Hussmann brackets.

Often (not necessarily always) you'll need to adjust right end metal tab (pull it out slightly using pliers 1/8"). This is more common on ID6SU12 cases. You may not have to do this on ID6SU8 cases.

Pro-Tip #3 is to pull out metal pin on right-end (spring end) approx. 1/8" BEFORE installing. **Take care to ensure you don't accidentally pull the pin all the way out.** See page 2 Troubleshooting to learn more.

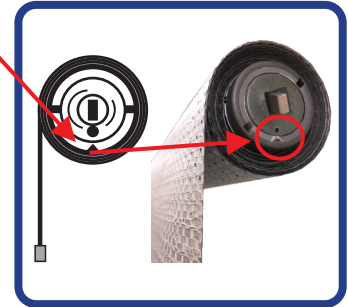

INSTALLATION

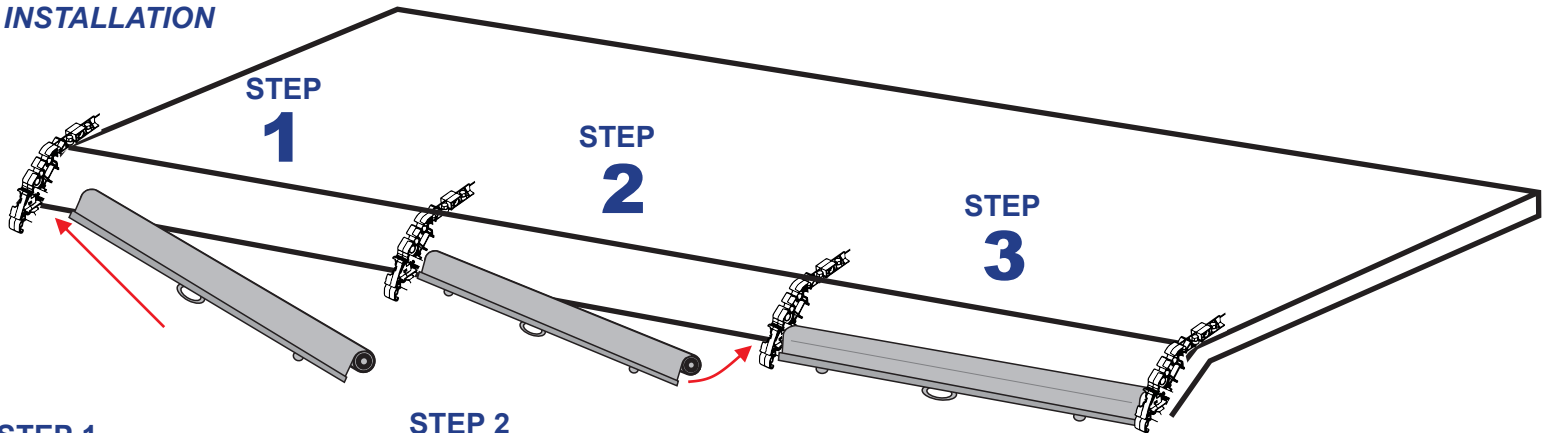

STEP 1

Slide the left-end of night cover into metal bracket cutout

Left section of case ALWAYS uses the **front** cutout. Alternate front & rear cutout for remaining sections.

Metal night cover bracket [LEFT END of Section]

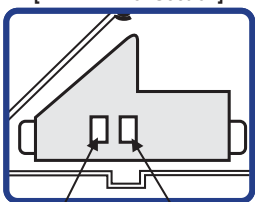

Front Cutout Rear Cutout

STEP 2

Swing right-end of night cover into plastic slot on canopy support arm

Left section of case ALWAYS uses the **bottom** slot. Alternate bottom & top slots for remaining sections.

Plastic night cover slots [RIGHT END of Section]

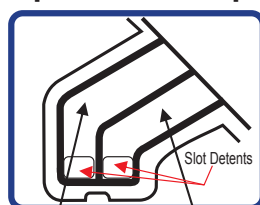

Top Slot Bottom Slot

STEP 3

Push/pull down on night cover to slide metal tab past detent. You should hear a small audible 'click', and/or feel it 'click' in.

See page 2 Troubleshooting to learn more.

When left-end of night cover is in **front cutout**, right-end should be in **bottom slot**.

When left-end of night cover is in **rear cutout**, right-end should be in **top slot**.

STEP 4

Check metal tab engagement to ensure it has 'clicked' in and at least 3/16" of metal tab is firmly in the slot detent. This corresponds with Step 3 above.

See page 2 Troubleshooting to learn more.

Questions? 1-800-519-1222
info@econofrost.com

Troubleshooting Page 2

Troubleshooting (INSIGHT)

XL Series Retrofit Non-Cassette

Specifically for Hussmann Insight Cases

ID6SU4 • ID6SU6 • ID6SU8 • ID6SU12

These instructions may also apply to additional case model numbers.

Econofrost' installation instructions, troubleshooting, tips & suggestions are written on the condition that Hussmann has pre-installed the required brackets in the Insight ID6SU12 & ID6SU8 cases. If you encounter a case that doesn't have the proper brackets installed, contact your Hussmann rep and order the part: **#0540452 - Support Canopy Arm**

Add/Release Spring Tension

Ensure 'dot & triangle' markings are at the **TOP** and the night cover is horizontal.

(a) If **ALL spring tension is lost**, then wind spring **CLOCKWISE** 14-15 times. After 14-15 winds, allow the winding tool to slowly release and lock (approx 1/4-1/2 turn counterclockwise). This can be a bit of trial & error, but make sure spring locks before removing winding tool.

(b) If adding the 'one wind' clockwise (from Pro-Tip #2 on first page), you must still allow the winding tool to slowly release and lock.

(c) To lessen spring tension (cover is retracting too fast). Use winding tool to release the spring and slowly allow the winding tool to turn **counterclockwise** the desired number of turns (to lessen spring tension). To re-lock the spring, turn winding tool **clockwise** one 'wind' (clockwise 360° turn of the spring) slowly release and the spring to lock; make sure the spring locks before removing the winding tool.

(d) If you don't have a winding tool, use vise grips.

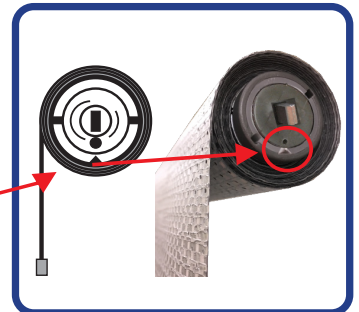

1. Night Cover only rolls up part way, then stops

This means night cover is not installed correctly. You must remove night cover from the brackets, and install again - taking care to ensure the 'dot & triangle' markings are at the bottom.

2. Fabric Releases but Spring Tension is NOT Lost

This almost certainly means that the metal tab on right-end of night cover is not properly clicked into detent slot on right-end bracket, and the metal tab on the right-end is freely rotating inside the slot on the right-end bracket. See Step 3 & 4 on Installation Instructions page.

Refer to Pro-Tip #3 on Installation Instructions page. As the metal tab is slightly adjustable, you may need to pull it out a slightly bit more (use pliers, but take caution). Adjusting the length of the metal tab slightly allows it to 'click' into the slot detent and catch. **Remember** that the "dot & triangle" must be at the bottom when installing/re-installing.

3. Metal Tab (on right-end of night cover) is accidentally pulled all the way out

This is not a problem; you can just put it back in. Night cover will work as intended as long as spring tension has not been lost. It does not matter which end (of the metal tab) is inserted first. However, if you lose this metal tab, night cover cannot be installed or used.

If spring tension is also lost, see "Add/Release Spring Tension" at top of this page.

4. Night Cover fabric is rubbing/catching on edges of the brackets

There are likely two different reasons that could cause this:

(a) **Night cover was pulled down crookedly** (on an angle) and allowed to roll up crookedly. If this is the case, pull night cover almost all the way out (approx. 6ft 2 inches) toward yourself and begin walking toward the case allowing the fabric to retract straight and evenly. You may have to do this 1 or 2 times to ensure the fabric gets back on track perfectly straight.

(b) **Night cover has been installed into the wrong bracket cutout/slot combination.** See Step 1 on Installation Instructions page. Double check that you have the night cover installed accordingly to Steps 1 & 2, and you are following the "alternating front & rear cutout" instruction as found on Installation instructions page.

(c) **If there were night covers previously installed in the cases**, do not simply install Econofrost night covers into whichever bracket cutout/slot combination the previous night cover was installed. You must follow the sequence outlined on Step 1 on the Installation instructions page. This might mean re-installing ALL the night covers in the case section (whether 12ft or 8ft), then alternating the front and rear bracket cutouts and slot combinations as per Step 1 on the Installation instructions page.